



Thunder Studios

Events & Venue Information





Welcome to Thunder

For decades, Thunder has been the creative home behind some of the world's most iconic music videos, commercials, and television shows. Today, after an exciting remodel and retrofit, we are proud to open our historic 150,000 sq ft campus for public and private events.

Preserving the authentic spirit of a working Hollywood film studio, Thunder offers a truly one-of-a-kind backdrop — where cinematic history meets modern event experiences. Whether you're planning an awards show, a sporting event, a wedding, an elegant gala, or a private celebration, our spaces are designed to inspire and elevate every occasion.

We are conveniently located at the edge of Carson and Long Beach, and just minutes from LAX, Long Beach Airport, and the LA Metro, Thunder Studios is ready to welcome you and your guests for an event experience unlike any other.

We look forward to bringing your vision to life at Thunder.

Rolando Nichols
President & General Manager



Event Spaces

An active Hollywood studio open to public and private events, with state of the art spaces, catering, lighting, audio, video and parking.

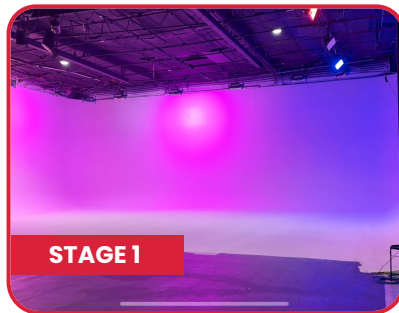
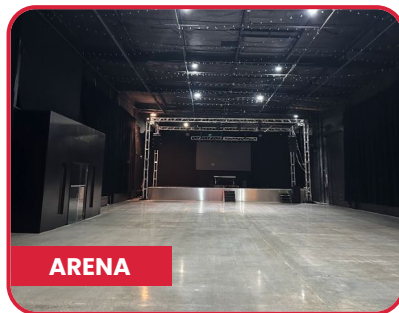

Space	Capacity
Stage 3 16,000 sq ft	3,000 Standing 1,500 Seating Theater Style 350 Banquet Dinner Style
Stage 14 15,000 sq ft	2,500 Standing 1,250 Seating Theater Style 300 Banquet Dinner Style
Arena 9,000 sq ft	1,000 Standing 500 Seating Theater Style 200 Banquet Dinner Style
Backlot 10,000 sq ft	3,000 Standing
LED Stage 4,000 sq ft	150 Standing 80 Seating Theater Style
Stage 1 7,400 sq ft	1,000 Standing 500 Seating Theater Style



Stage 3

Our largest film & event space, with 16,000 sq ft of black painted cement floors, and a 3-wall black cyclorama back wall with full grid.

Ideal for large capacity events such as combat sports, concerts, corporate events, ticketed parties, trade shows, and more.

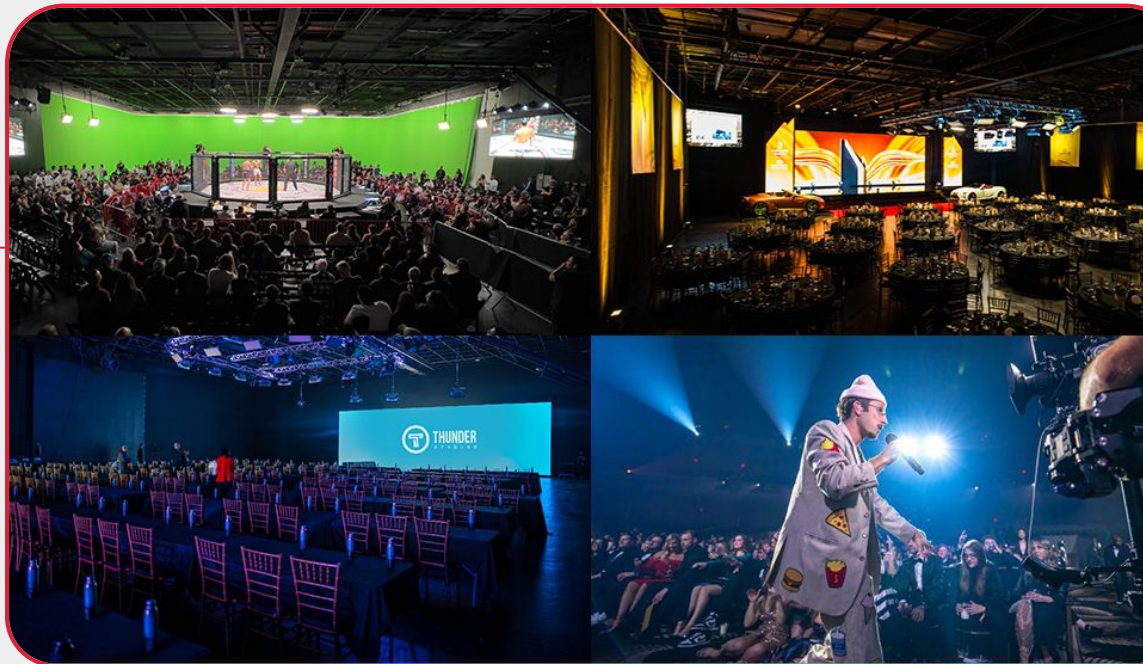

Stage 3

A 16,000 sq ft black canvas ready for action!



Stage Information

16,000 sq ft / Cement floors
3-Wall Black Cyclorama Wall, Full grid
Elephant Doors, Full Motion Gantry System

Lighting / Included

24x Arri S-60s, 8x Vizi Beam Lights on-grid,
10x Vizi Beam Lights on-stage, 2x Amhaze
Stadium Haze Machines, 2x Mole Richardson
412 Jr Solar.

Audio / Included

10x QSC K12.2 Powered Loudspeakers,
1x Audio Mixer: Yamaha M7CL 48-Channel Mx
2x Shure UR4D+ Wireless Transmitter,
capable for 4 RF Mics

LED Video Walls / Included

-Hanging 14.5'x8.2' ft Screen, 1.9mm
-Standing 9'x16' ft Screen, 3.6mm

Stage / Included

6' x 4' ft Steeldeck Platform, w/Center Stairs,
raised to 4ft height.

Network / Included

30mb Wifi
100mb Up/Down drops available



Stage 3

Floorplan & Layout

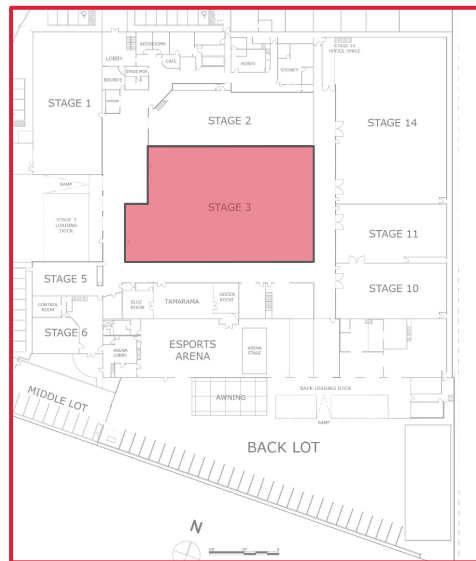

Highlights

- Capacity can be reduced to accommodate any custom layouts
- Custom layouts offered as additional service in-house
- Accessible via loading dock ramp from main parking lot
- AC Included up to 20-Tons, additional available upon request and charged per usage.
- Power included up to 1400 Amps, additional available upon request and charged per usage.
- Adjacent to Hallway with reception bar, restrooms, and private suites which are available as add ons



Stage 3

Summits

Galas

Live Events

Fundraisers

Receptions

Concerts

Auto Events

Product Launches

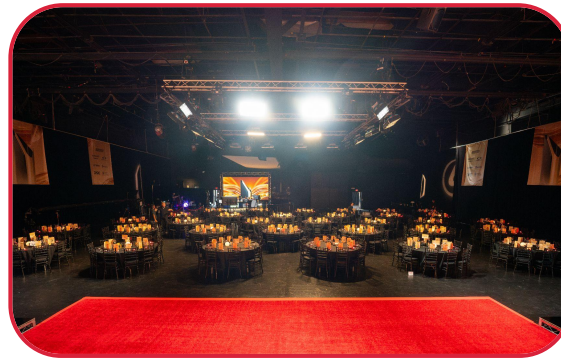

Stage 14

Our 2nd largest film & event space at 15,000 sq ft of black painted cement floors, and high ceilings.

Ideal for large capacity events, corporate events, ticketed parties, concerts, trade shows, and custom brand activations.

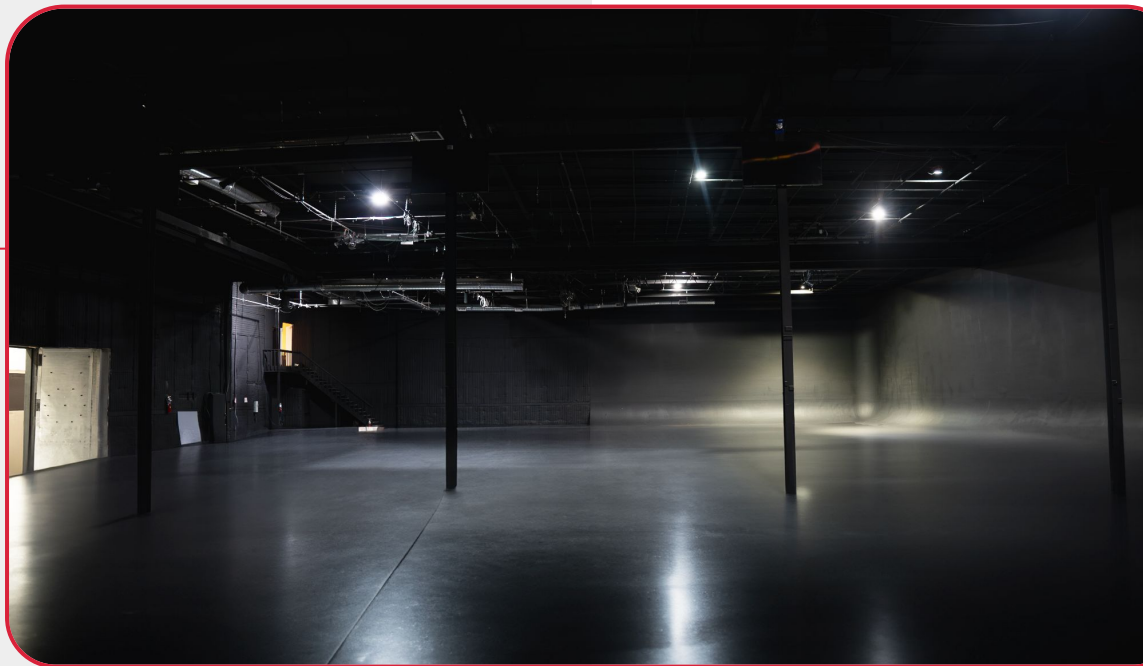

Stage 14

A 16,000 sq ft black canvas ready for action!

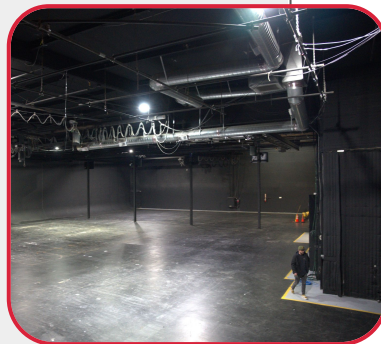
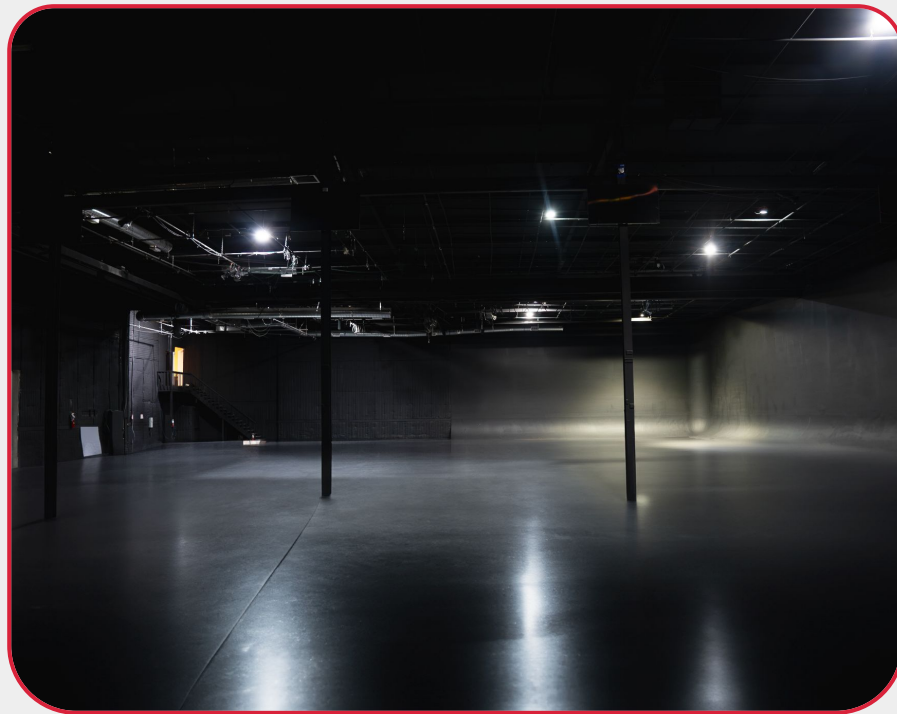

Stage Information

16,000 sq ft / Cement floors
3-Wall Black Cyclorama Wall, Full grid
Elephant Doors, Full Motion Gantry System

Lighting & Audio / Available add-on
Available packages and custom rentals,
tailored to your needs as requested.

LED Video Walls / Available add-on
Available custom configuration and
installations, tailored per event.

Stage / Included
6' x 4' ft Steeldeck Platform, w/Center Stairs,
raised up to 4 ft height.

Network / Included
30mb Wifi
100mb Up/Down drops available

Private Rooms / Included
4 Small offices are available on the second
floor, plus another 6 suites are available to
expand to as add ons, accessible via stairs
inside the stage.



Stage 14

Floorplan & Layout

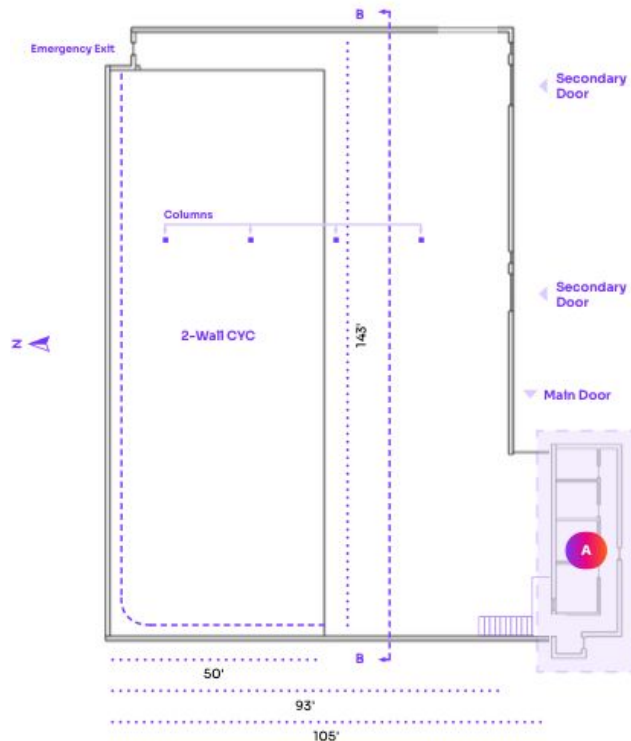
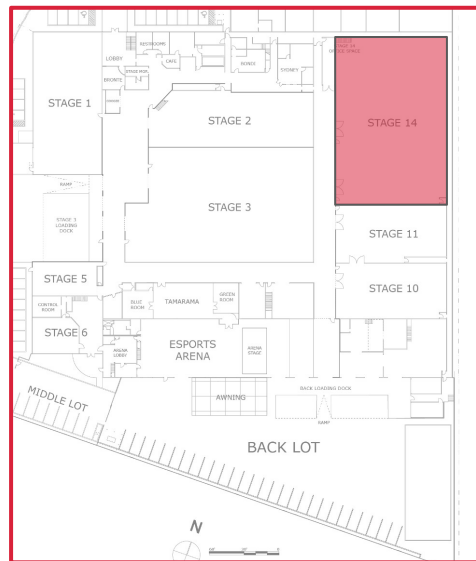

Highlights

- Capacity can be reduced to accommodate any custom layouts
- Custom layouts offered as additional service in-house
- AC Included up to 20-Tons, additional available upon request and charged per usage.
- Power included up to 1400 Amps, additional available upon request and charged per usage.
- Includes use of 4 small offices above
- Adjacent to 1st floor private suites
- Accessible via lobby or backlot loading dock ramp.



Stage 14

Keynotes

Galas

Live Shows

Red Carpet Events

Receptions

Concerts

Auto Events

Product Launches

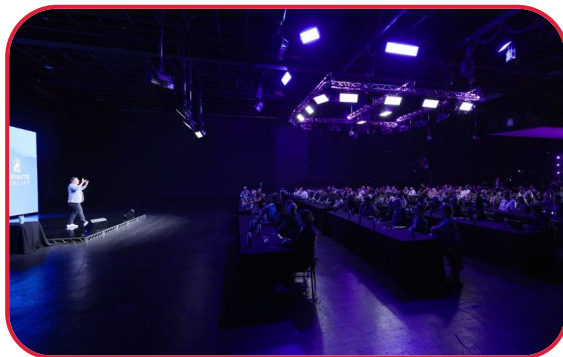

The Arena

One of our most versatile venues, The Arena is a dynamic blank canvas featuring a built-in main stage, full truss system, and open floor plan ideal for high-capacity events. Whether you're hosting a live concert, elegant gala, product launch, or speaking engagement, this space adapts seamlessly to your vision. With ample room for custom lighting, staging, and guest experiences, The Arena is designed to make a bold statement at any scale.



The Arena

A 16,000 sq ft black canvas ready for action!



Stage Information

16,000 sq ft / Cement floors

3-Wall Black Cyclorama Wall, Full grid

Elephant Doors, Full Motion Gantry System

Lighting & Audio / Available add-on
Available packages and custom rentals.

LED Video Walls / Available add-on
Available add ons in-house

Stage / Included
40'w x 14'd ft Steeldeck Platform, w/Side
Stairs, raised to up to 4 ft height, includes
truss backing.

Network / Included
30mb Wifi
100mb Up/Down drops available

Private Room / Included
One Lounge space available upstairs with
private restroom.

Highlights
Private parking access for private events
available, as well as new restrooms with ADA
Stalls



The Arena

Floorplan & Layout

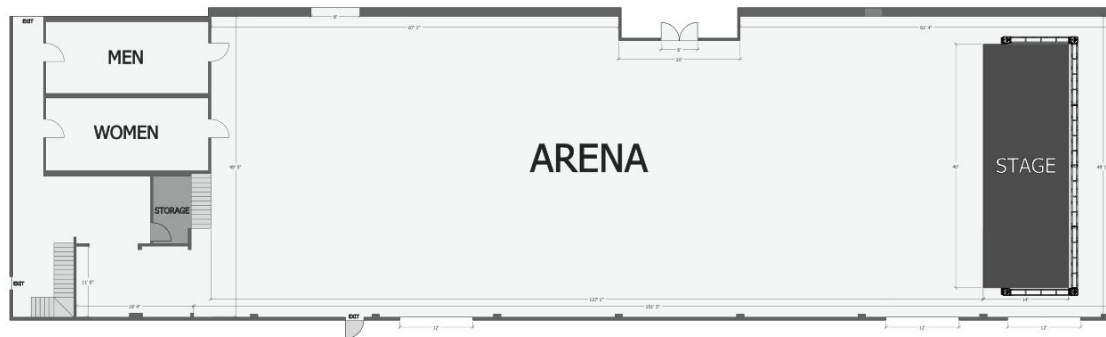

Highlights

- Capacity can be reduced to accommodate any custom layouts
- AC Included up to 10-Tons, additional available upon request and charged per usage.
- Power included up to 1400 Amps, additional available upon request and charged per usage.
- Includes use of 1 lounge accessible via stairs from the stage floor
- Brand New Restrooms
- Accessible via lobby or backlot loading dock ramp.



The Arena

Floorplan & Layout 2: When Booked with Hollywood and Backlot Spaces

Highlights

- Combined layout of all 3 spaces is recommended for events over the Arena Capacity, or with desire to have indoor and outdoor event spaces activated.

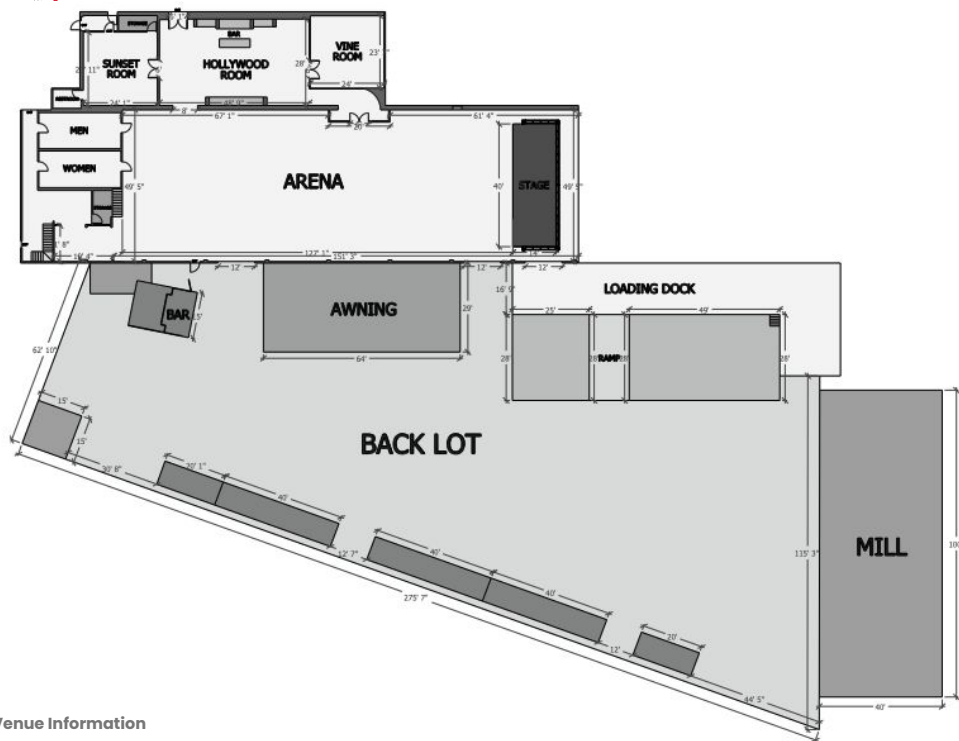

The Arena

Concerts
Weddings

Galas
Keynotes

Live Shows
Auto Events

Gaming Events
Brand Events



LED Stage

An immersive, high-tech space designed for intimate gatherings, private screenings, and unforgettable experiences. Featuring a large LED volume with cinematic resolution, this stage creates dynamic environments perfect for visually driven events, presentations, or branded content. Ideal for groups seeking a unique and futuristic setting.



LED Stage

A 16,000 sq ft black canvas ready for action!



Stage Information

4,000 sq ft / Cement black floors
LED Ceiling on Motion Gantry System
Elephant Doors, Full Grid, black walls

Lighting & Audio / Available add-on
Available packages available a la carte

LED Video Specs / Included
7600x2000 px resolution
64 ft curved x 14.5 ft H, with a 40" diameter

Stage / Available add-on
Platforms available for rental

Network / Included
30mb Wifi
100mb Up/Down drops available

Private Rooms / Available add-on
Nearby lounges and suites are available as add-on rentals



LED Stage

Floorplan & Layout

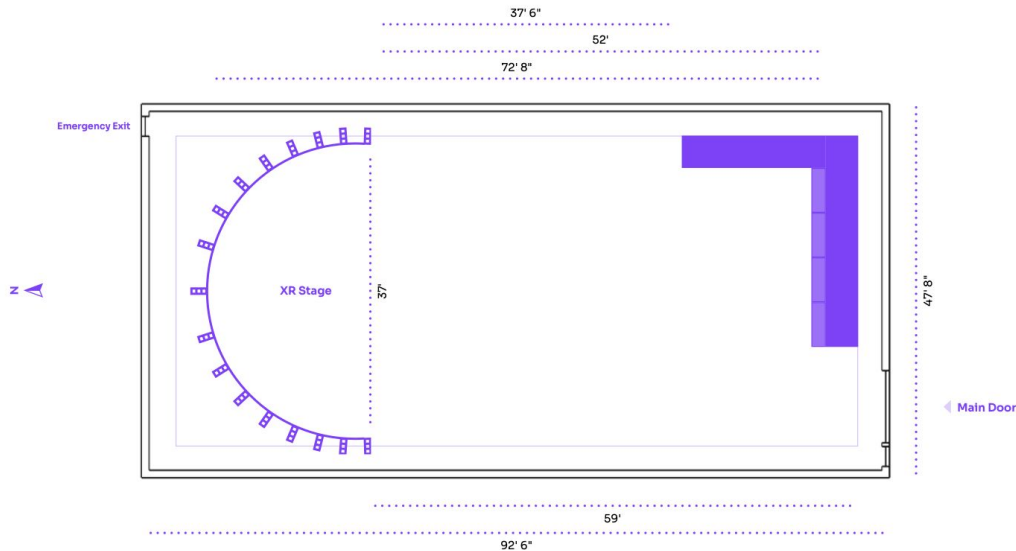
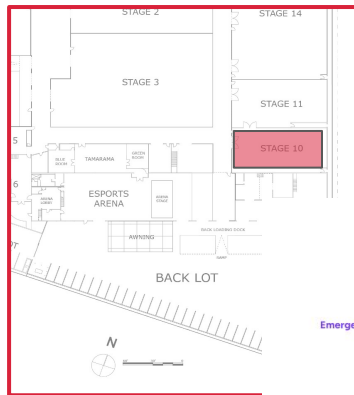

Highlights

- Capacity can be reduced to accommodate custom layouts
- Custom layouts offered as additional service in-house
- AC Included up to 20-Tons, additional available upon request and charged per usage.
- Power included up to 1400 Amps, additional available upon request and charged per usage.
- Includes use of LED Wall and Ceiling
- Adjacent to 1st floor private suites, which are available as add ons
- Accessible via lobby or backlot loading dock ramp.



LED Stage

Screenings

Panels

Press Rounds

Wedding Ceremonies

Premieres

Cocktail Hrs

Experientials

Live Podcasts



The Backlot

An expansive 10,000 sq ft outdoor space with an urban-industrial vibe, The Backlot is ideal for open-air events like food festivals, networking mixers, brand activations, and community fairs. It features a built-in awning area, a stylish outdoor bar, and plenty of room for custom builds or activations. Versatile and easy to transform, The Backlot blends the raw energy of a studio lot with the flexibility of a blank canvas — perfect for experiences that need room to grow.



The Backlot

An open space with flexible configurations

Stage Information

10,000 sq ft / Cement floors
Independent parking lot access



Lighting & Audio / Available add-on
Available packages and custom rentals,
tailored to your needs as requested.

LED Video Walls / Available add-on
Available custom configuration and
installations, tailored per event.

Stage / Optional
6' x 4' ft Steeldeck Platform, w/Center Stairs,
raised to 4ft height.

Network / Included
30mb Wifi
100mb Up/Down drops available

Private Rooms / Included
4 Small offices are available on the second
floor, plus another 6 suites are available to
expand to as add ons, accessible via stairs
inside the stage.



The Backlot

Outdoor space with flexible configurations

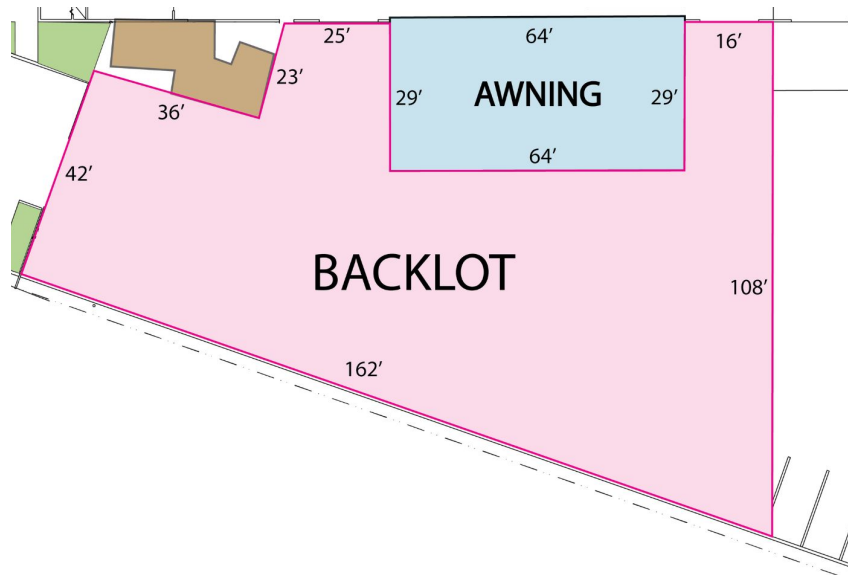
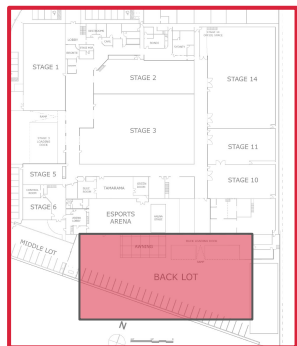

Highlights

- Capacity can be reduced to accommodate any custom layouts
- Custom layouts offered as additional service in-house
- AC Included up to 20-Tons, additional available upon request and charged per usage.
- Power included up to 1400 Amps, additional available upon request and charged per usage.
- Includes use of 4 small offices above
- Adjacent to 1st floor private suites
- Accessible via lobby or backlot loading dock ramp.



The Backlot

Concerts

Galas

Live Shows

Gaming Events

Weddings

Keynotes

Auto Events

Brand Events



Stage 1

A 7,400 sq ft venue stage reimagined for high-impact events. Featuring a three-wall pre-lit cyclorama, soaring ceilings, and direct access from the parking lot via oversized elephant doors, Stage 1 is both flexible and dramatic. With room to host up to 1,000 guests, this space is ideal for immersive brand moments, large-scale celebrations, and presentations that demand a cinematic edge.



Stage 1

Convenient medium size space with color cyc

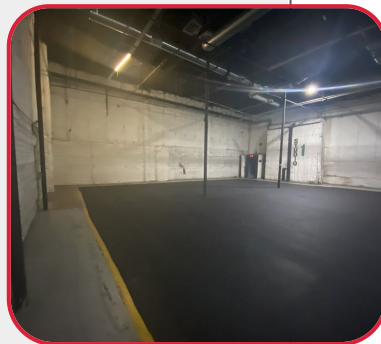

Stage Information

7,300 sq ft / Cement floors

3-Wall white Cyclorama Wall, pre-lit

Elephant Doors, Full Grid

Lighting & Audio / Available add-on
Available packages and custom rentals,
tailored to your needs as requested.

Pre Lit at no additional cost, RGB System

LED Video Walls / Available add-on
Available custom configuration and
installations, tailored per event.

Stage / Included
6' x 4' ft Steeldeck Platform, w/Center Stairs,
raised up to 4ft height.

Network / Included
30mb Wifi
100mb Up/Down drops available



Stage 1

Convenient medium size space with color cyc

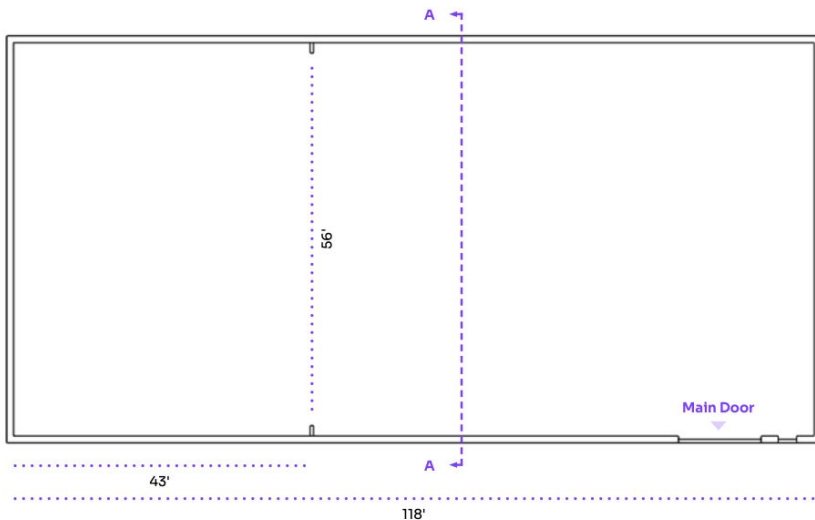
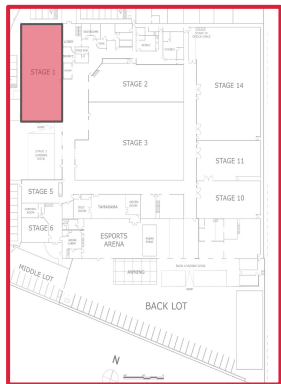

West Elevation Stage Doors



Highlights

- Capacity can be reduced to accommodate custom layouts
- AC Included up to 10-Tons, additional available upon request and charged per usage.
- Power included up to 1400 Amps, additional available upon request and charged per usage.
- Adjacent to 1st floor private suites
- Direct access from parking lot available, as well as from private lobby



Stage 1

Keynotes

Podcasts

Talk Shows

Interviews

Cocktail Hours

Brand Events

Business Events

Industry Parties

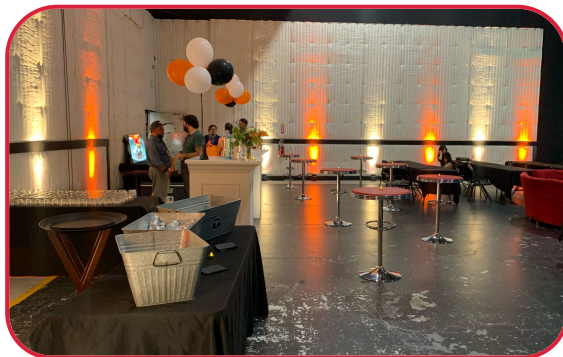

Additional Spaces





Hollywood Lounge, Sunset & Vine

A moody, cinematic lounge inspired by the glamour of 1950s Hollywood speakeasies, featuring ambient lighting, rich textures, and a sophisticated palette of deep reds and charcoal. The space accommodates up to 100 guests standing, with customizable seating configurations available to suit your event's needs.

Adjacent to the lounge are two private suites, each comfortably hosting up to 25 guests. One suite includes a private restroom, offering an added layer of convenience and exclusivity.





Thunder Cafe

A vibrant, 1960s-inspired café and concession stand designed with a sleek, modern aesthetic — fully operational for events requiring food and beverage service. The space can be custom-branded and themed to complement your event, adding a playful yet polished touch to the guest experience.

The café is located next to a curated awards display that celebrates the rich history of Thunder Studios' productions, and is directly connected to a commercial-grade kitchen operated by our in-house catering team.



The Marquee Bar

A glamorous on-site bar channeling the allure of 1950s Hollywood, The Marquee is inspired by the golden age of cinema — think black-and-white films, red lips, and the timeless charm of Marilyn Monroe.

Featuring an original photo mural of Marilyn and a double-sided bar designed for high-volume service, it's the perfect centerpiece for cocktail hours, receptions, and late-night celebrations.





The Bondi, Lux Suite

A private, luxury retreat designed for comfort and convenience. The Bondi features a full bathroom with shower, a dedicated hair and makeup station with professional vanity lighting, and a cozy lounge area complete with a fridge. Perfect as a glam suite, green room, or personal escape during your event, The Bondi offers a quiet moment of calm behind the scenes.

Psst. It's Taylor's favorite when she visits us!



The Sydney, Luxury Lounge

An elegant, spacious lounge designed with versatility in mind. The Sydney features a large central conference table, two private offices, and a stylish living room area — perfect for talent holding, production teams, or group prep. With its high-end finishes and adaptable layout, the space can be reconfigured to suit your event's flow, offering both functionality and sophistication behind the scenes.



At Thunder, we offer more than spaces.

Everything you need, all in one place.

From full-service catering to equipment rentals and on-site production support, Thunder Studios offers a comprehensive suite of services to elevate your event. Whether you're planning an intimate gathering or a large-scale production, our in-house teams ensure a seamless experience from concept to execution.



**Catering &
Bar Services**

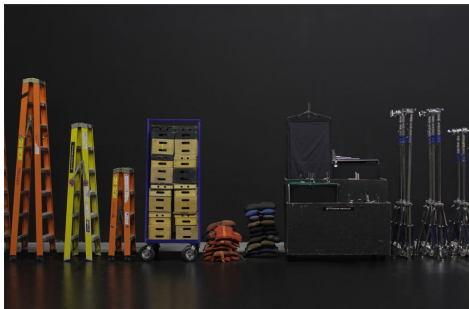

**Equipment
Rentals**



**Production
Services**



THANK YOU

Contact us to discuss
infinite opportunities together.

Sales@Thunderstudios.com

